

medusa

table / bench

The MEDUSA table/bench is a captivating addition to our mono-material object collection. Its serene design is artfully complemented by the tactile allure of its sculpted texture.

COLOR

Body: White with white marble specs, Sculpted texture.

Top: White with white marble specs. Smooth texture.

Very refined matte varnish

MATERIAL

Made from our own aggregate of stone, marble and cement. Mixed and poured by hand, our tables are assembled and sealed with a specialized highly protective coating, which makes the surface non-absorbent and spill resistant. The table can also be used outdoors without its metal safety footing, and as any natural material, it is recommended to be placed under covered area where there is no standing water. Slight variations in size and color are due to the use of natural materials and to the handmade nature of our products - each is unique. The MEDUSA table/bench comes in two pieces with no-tool assembly.

CRAFTING

Designed and handcrafted with high quality materials by ALENTEs in Greece, EU.

DIMENSIONS

L120cm W45cm H31cm approx 75.0kg

L47.2" W17.7" H12.2" approx 165.0lbs

CUSTOMIZATION

The MEDUSA table/bench can be modified in length, height and width upon request.

LEAD TIME

8-10 WEEKS unless otherwise stated



medusa

table / bench

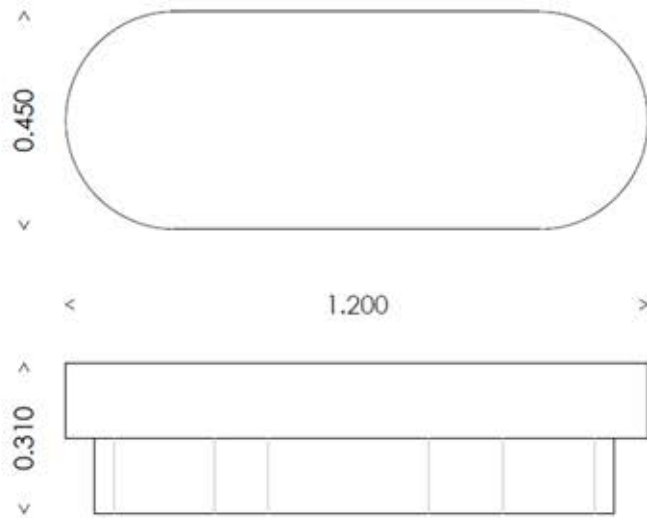

CARE GUIDE

PURPOSE

This table/bench is intended for indoors. Due to its durable material, it can also be used outdoors, without its metal base, however not in standing water or inclement weather. Its only care is in the careful moving, as it is practically care free. Because of its sturdy weight balance, accidental or wind tipping is almost impossible.

LIFT

Lift table top and table base gently, vertically and with both hands.

PLACE

Place table top and table base gently, vertically and

with both hands.

DO

Use the table indoors and outdoors. When outdoors, store under covered area where there is no standing water - cover/store indoors during inclement weather. Store table individually - not stackable. Clean with just damp cloth.

DON'T

Don't pull, drop or drag table. Don't tilt the table on its base to lift it. Don't drop hard/heavy objects on top surface edges. Don't leave spills unattended. Don't use hard chemicals to clean. Don't rest shoes on top surface edge. Don't sit on, stand on or use as stepping ladder.

COLOUR AND OTHER VARIATIONS

Customary and reasonable variations in color and/or dimensions of ALENTEs objects are a testament to their handmade nature, and are thus not considered as a defect. Hairline cracks are surface deep and are part of the casting process - all items are carefully quality inspected before shipping.

DAMAGE DURING SHIPPING

ALENTEs packages its goods according to fragile items method, so as to minimise any breakage during shipping. Unpack and inspect your order immediately upon delivery. In case of damage during shipping, send us an email with a report and photographic evidence within 3 working days upon delivery. All our shipments are insured for damages during transport, so any damaged good during shipping will most likely be replaced.

RETURNS

Since our products are made upon demand, we do not accept returns if there is no technical default.

GUARANTEE

We guarantee that all ALENTEs products sold directly from ALENTEs are free from manufacturing faults and defects for a period of 24 months from the date of original delivery. In the event that a product is proven to be defective, you are entitled to the restoration of the goods through repair or replacement, whichever is decided as being the most efficient and effective remedy. The guarantee does cover:

- Possible dismantling of the object's parts
- Casting cracks that are larger than hairline cracks (>1.0mm)

The guarantee does not cover:

- Damages that are caused by not following the CARE GUIDE instructions by erroneous maintenance and/or improper use of the goods
- Chipping of top/bottom edges resulting from not following the CARE GUIDE instructions
- Water corrosion damage that results from not following the CARE GUIDE instructions
- Discoloration due to weather conditions
- Hairline cracks that 1.0mm or smaller

DEFECTIVE PRODUCT

In the rare case your product is faulty, we will consider your claim as quickly as possible and correct it to the best of our ability. Based on your photographs, we will assess whether the complaint is based on a deficiency of manufacturing or of material nature, or whether it is due to normal wear and tear. Defective items will be replaced or refunded if the replacement with the same product is not possible. We will arrange with you to send us the item back and we will replace it free of charge and shipping costs. We will operate with the utmost speed in order to reduce waiting times. If you have purchased products through one of our associated stores, the guarantee also applies, but not to any defects, damage or wear that the products have been sold with.